



Lochinvar®

LIGHT DUTY COMMERCIAL ELECTRIC WATER HEATER

Submittal Sheet

CLD-Sub-05

LIGHT DUTY COMMERCIAL ELECTRIC WATER HEATERS

Job Name: _____
 Location: _____
 Engineer: _____
 Agent/Wholesaler: _____
 Contractor: _____

Model No. _____ Gal. Cap. _____
 Voltage/Phase _____ kW _____
 Recovery Rate in GPH _____ @ _____ °F Rise
 Equipment Tag(s): _____

NOTES:

Standard Features

- Meets ASHRAE Energy Efficiency Standards.
- 300 psi Test Pressure, 150 psi Working Pressure.
- Glass-Lined Steel Tank
- Non-CFC Foam Insulation
- Adjustable Thermostats
- Automatic Overheat Protection
- Tank Saver Anode
- Temperature and Pressure Relief Valve
- 3 Year Limited Tank Warranty, 1 Year Limited Parts Warranty (See warranty for details)

Dimensions

Model No.	Gal. Cap.	A	B	C	D	Ship Wgt.
-----------	-----------	---	---	---	---	-----------

Point-of-Use Models

EJW006FS	6	15-1/2"	14-1/4"	11"	-	35
EJW010FS	10	18-1/4"	18"	12-1/2"	-	54
EJW015FS	15	26"	18"	20-1/2"	-	58
EJW020FS	20	22-1/4"	21-3/4"	15-1/2"	-	73

Short Models

ESX030KD	30	31"	21-3/4"	24-1/4"	8"	109
ESX040KD	40	32-1/4"	24"	25-1/2"	8"	138
ESX050KD	50	32-1/4"	26-1/2"	25-1/4"	8"	184

Tall Models

ETX030KD	30	34-1/2"	20-1/2"	-	8"	105
ETX040KD	40	45-1/4"	20-1/2"	-	8"	122
ETX050KD	50	55"	20-1/2"	-	8"	140
ETX065KD	66	60-3/4"	21-3/4"	-	8"	166
ETX080KD	80	59-1/2"	24"	-	8"	200
ETX120KD	119	62-1/2"	29-1/2"	-	8"	337

"S" indicates single element, "D" indicates dual elements

Point-of-Use Models

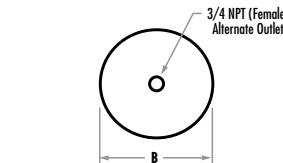

TOP VIEW - P.O.U. 6/10/15/20

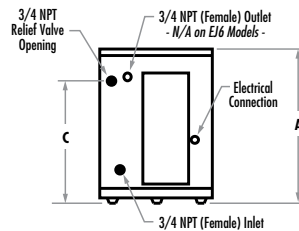

FRONT VIEW - EJ 6/10/15/20

NOTES:

Point of Use models are non-simultaneous circuit only.

P.O.U. models available in single phase only.

6 gallon P.O.U. not available above 3000 Watts.

Short & Tall models are factory wired for three phase service and are field converted to single phase.

Short Models

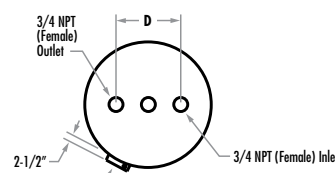

TOP VIEW - ES 30/40/50

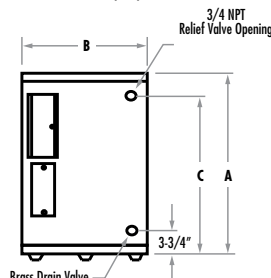

FRONT VIEW - ES 30/40/50

Tall Models

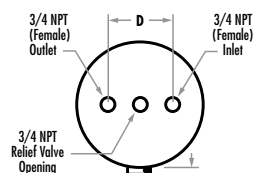

TOP VIEW - ET 30 - 120

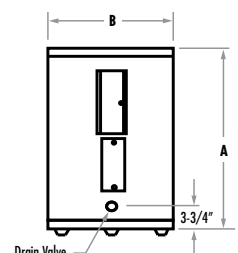

FRONT VIEW - ET 30 - 120

LIGHT DUTY COMMERCIAL MODELS - SPECIFICATIONS & OPTIONS



For Ease in Ordering
by Model Number

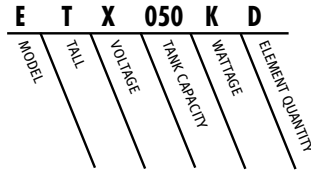

ETX050KD is:

- Commercial Electric Model
- Tall Style
- 480 Volts
- 50 gallon tank capacity
- 4500 watt element (ea.)
- Two elements (Dual - upper & lower)

VOLTAGE SCHEDULE (EJ Models)

C	120V	1 PH
J	208V	1 PH
A	240V	1 PH
W	277V	1 PH
V	480V	1 PH

(ES & ET Models)

T	208V	1 or 3 PH
P	240V	1 or 3 PH
W	277V	1 PH
X	480V	1 or 3 PH

WATTAGE LIMITS w/Simultaneous Operation

208V - 10,000W (5,000W/5,000W)
240V - 11,000W (5,500W/5,500W)
277V - 12,000W (6,000W/6,000W)
480V - 12,000W (6,000W/6,000W)

ELEMENT AVAILABILITY SCHEDULE

Wattage	ELEMENT AVAILABILITY SCHEDULE					RECOVERY RATE (GPH @ °F)			
	120V	208V	240V	277V	480V	40°F	70°F	100°F	130°F
C-1500	Yes	Yes	Yes	Yes	N/A	16	9	6	5
D-1650	N/A	N/A	N/A	N/A	N/A	17	10	7	5
E-2000	Yes	Yes	Yes	Yes	N/A	21	12	8	6
F-2500	Yes	Yes	Yes	Yes	Yes	26	15	10	8
G-3000	Yes	Yes	Yes	Yes	Yes	31	18	12	10
H-3500	N/A	Yes	Yes	N/A	N/A	36	21	14	11
J-4000	N/A	Yes	Yes	Yes	Yes	41	24	17	13
K-4500	N/A	Yes	Yes	Yes	Yes	47	27	19	14
M-5000	N/A	Yes*	Yes*	N/A	Yes*	52	30	21	16
N-5500	N/A	N/A	Yes*	N/A	N/A	57	32	23	17
P-6000	N/A	Yes	Yes	Yes	Yes	62	35	25	19

Notes: Max Wattage for EJ-006 is 3000W * Indicates Not Available for EJ-010 and EJ-015

FULL LOAD CURRENT IN AMPERES

Input Wattage	Single Phase					Three Phase		
	120V	208V	240V	277V	480V	208V	240V	480V
1500	12.5	7.2	6.3	5.4		4.2	3.6	
2000	16.7	9.6	8.3	7.2		5.6	4.8	
2500	20.8	12.0	10.4	9.0	5.2	6.9	6.0	3.0
3000	25.0	14.4	12.5	10.8	6.3	8.3	7.2	3.6
3500		16.8	14.6			9.7	8.4	
4000		19.2	16.7	14.4	8.3	11.1	9.6	4.8
4500		21.6	18.8	16.2	9.4	12.5	10.8	5.4
5000		24.0	20.8		10.4	13.9	12.0	6.0
5500			22.9	21.7			13.2	
6000		28.8	25.0		12.6	16.7	14.4	7.2

Double the amps when wired for simultaneous operation.
See Wattage Limit chart for maximum simultaneous wiring.



Lochinvar, LLC
300 Maddox Simpson Parkway
Lebanon, Tennessee 37090
P: 615.889.8900 / F: 615.547.1000
f t i n Lochinvar.com



LOW LEAD CONTENT